

# DOWNTOWN PARCEL SURPLUS

1800  
MAIN STREET

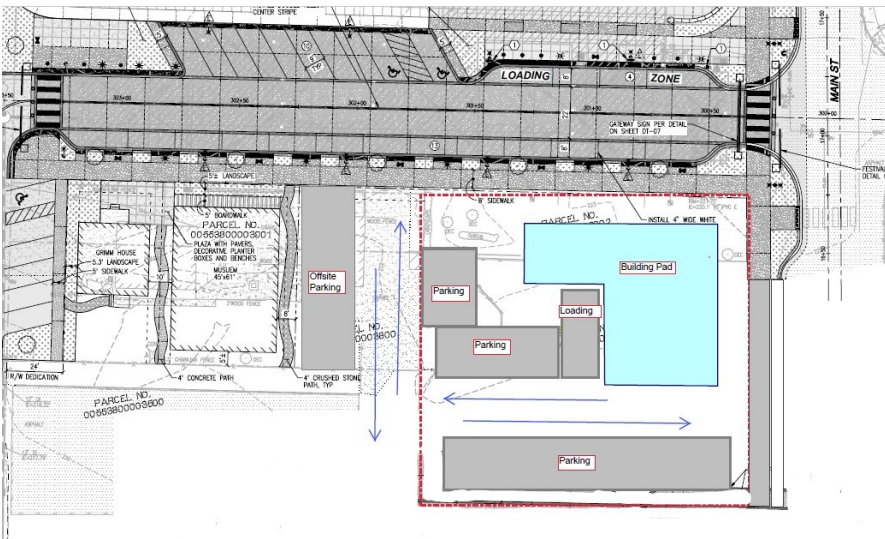

## Conceptual Site Plan

### Property Information

**Description:** Commercial property at the intersection of Main Street and 18<sup>th</sup> Street NE, adjacent to the recently renovated North Cove Park and the newly built Mill. Excellent commercial visibility off Main Street and 18<sup>th</sup> Street NE. Flexible zoning for a mixed-use development. Views of lake and North Cove Park.

**Zoning:** Central Business District

**Property Size:** Approximately 18,450 square feet

**Estimated Sales Price:** \$498,150 (\$27.00 per sq. ft.)

**Sale Terms:** Subject to City Council approval and execution of a development agreement

## Parcel Map

### Contact Information

Russ Wright  
rwright@lakestevenswa.gov  
425-622-9424



# Conceptual Building & Block Design



Above - Mill Spur looking west from Main Street



Left - Proposed Mixed-Use Building from Main Street looking northwest

Right - Proposed Mixed-Use Building looking southeast from Mill Spur

